

SunFX® FREESTYLE USERS MANUAL



THANK YOU for choosing the SunFX FREESTYLE Spray Tan System. Please read the following to help assist you with the set up and maintenance of your spray tan unit.

TECHNICAL SPECIFICATIONS

Charging Voltage	110-240V-50/60Hz
Battery Capacity	DC12V Li-Ion 2200mAh
Rated Power	55W
Solution Cup	200ml
Nozzle Dia.	0.5mm
Charging Time	52-55 min
Working Time	22-25 min

SPRAY APPLICATOR

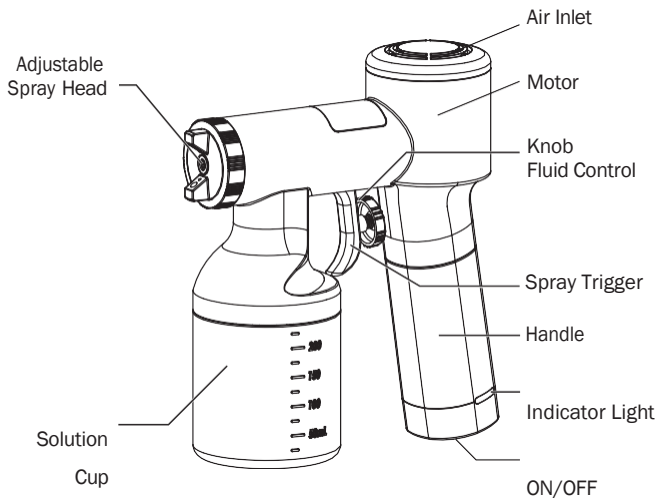

SPRAY APPLICATOR



STEP 1

Unscrew the solution cup and fill to $\frac{3}{4}$ full. Overfilling the solution cup may cause leaks.



STEP 2

Insert solution cup and screw tightly.

SPRAY APPLICATOR



STEP 3

Rotation atomizing spray head Shape regulate.

Rotation atomizing spray head vertical position for up and down spraying.



Rotation atomizing spray head horizontal position for left to right spraying.



SPRAY APPLICATOR



STEP 4

Adjust the fluid control knob to meet your requirement. Adjust the knob to left to decrease airflow and solution volume, lower solution thickness. Adjust the knob to right to increase airflow and solution volume, increase solution thickness.

SPRAY APPLICATOR



STEP 5

Press the switch button to start the motor.
Press again to stop the motor running.

SPRAY APPLICATOR



STEP 6

When removing the battery, press the lock button with your finger and pull the battery apart with your hand. When installing the battery, push the battery interface to the end of the applicator body, it will automatically lock.

SPRAY APPLICATOR



INDICATOR LIGHT

When the device is working normally, the indicator light will glow blue.

When the battery usage is 50% (only 50% left), indicator light turns red.

When the battery usage is 95% (only 5% left), the red indicator light will start flashing, please stop using the device, remove battery and connect to USB charger.

When charging the device, the indicator light pulses blue while charging. When fully charged, the indicator light glows blue.

SPRAY APPLICATOR MAINTENANCE GUIDE

- **STEP 1** Arming the oscilloscope sweep.
- **STEP 2** Unscrew solution cup and empty any excess solution. It is recommended that this be done over a sink or wet area.
- **STEP 3** Rinse the empty solution cup with water.
- **STEP 4** Refill the cup with water and screw back into the applicator, fix the solution dial to 'maximum discharge' and spray until the water runs clear. Rinse and repeat if required.
- **STEP 5** Empty solution cup and re-set the solution dial on the back of the gun to the regular spray setting.
- **STEP 6** Wipe any excess water from the applicator with a cloth and leave out to dry.
- **STEP 7** Charge the battery in time when the indicator is red.
- **STEP 8** If you do not use the applicator for a long time, please fully charge the battery before use.

SPRAY APPLICATOR MAINTENANCE GUIDE

Secondary maintenance must be run on the applicator every 2-4 weeks or when required. Secondary maintenance will deliver a more thorough clean to prevent or clear any blockages and maintain the applicators performance.

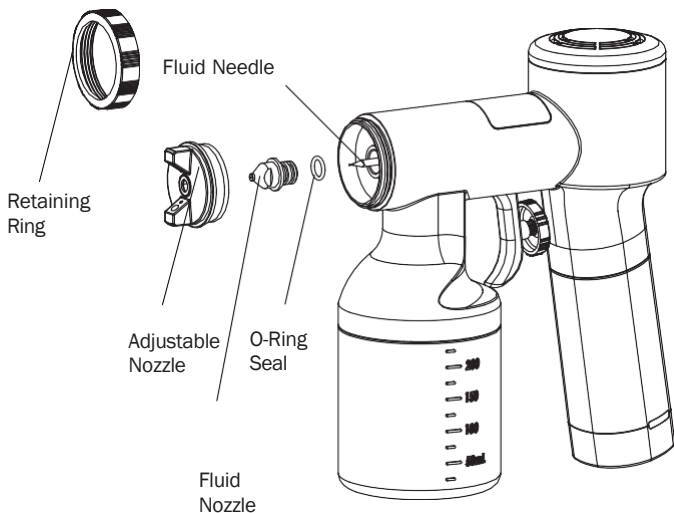







SPRAY APPLICATOR MAINTENANCE GUIDE

TROUBLESHOOTING - BLOCKED NOZZLE OR CONTINUOUS SPRAY WITHOUT PRESSING THE TRIGGER.

- **STEP 1** Locate and unscrew retaining ring. To release; turn retaining ring in an anti-clockwise motion.
- **STEP 2** Gently pull on the adjustable nozzle to remove.
- **STEP 3** Fit an 8mm spanner to the edges of the fluid nozzle and turn anti-clockwise to unscrew.
- **STEP 4** Ensure you do not misplace the o-ring seal, which is located behind the fluid nozzle.
- **STEP 5** Empty solution cup and re-set the solution dial on the back of the gun to the regular spray setting.
- **STEP 6** Once removed, visually inspect the fluid nozzle to see if there is small particles or blockages.
Rinse thoroughly with water.
- **STEP 7** Gently wipe the fluid needle to clean and remove any debris (the fluid needle should not be removed from the applicator at any time).
- **STEP 8** Once visually clear of any debris, re-attach fluid nozzle, make sure the O-ring is in position, then use the spanner (8mm) to gently tighten back into place.
- **STEP 9** Replace adjustable nozzle and rotate back into position.
- **STEP 10** Repeat previous steps if required.

WARNING!

In this manual and/or on the machine the following symbols are used:

	No watering!
	Risk of fire!
	Put the battery into the trash can sign.
	Do not expose charger and battery pack to water.
	Read manual before use.
	Recovery and environmental protection.

SPECIAL ATTENTION

1. Please fully charge the battery before use.
2. Only use our adaptor to charge the applicator.
Don't use other USB devices to charge, this may cause damaged.
3. Please clean the machine after use.
4. When cleaning the machine, please make sure water does not enter into motor part and handle part.
5. The machine must be fully charged once every month during storge to protect the battery life.

Thanks for reading the manual. If you have any question or suggestion please contact our team at info@sunfxamerica.com